

COUPLERS & PLUGS

Shown below and on page 12 are "actual size" layouts of our coupler and plug offering. These layouts can be used for envelope dimensions as well as identifying body size and interchange by the plug profile.

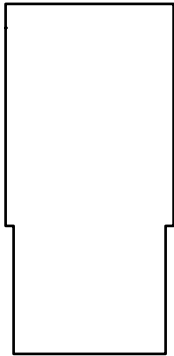

Type:
CI4C
CA4C
CT4C

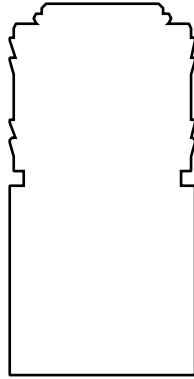

Type:
CI4S
CA4S
CE4S

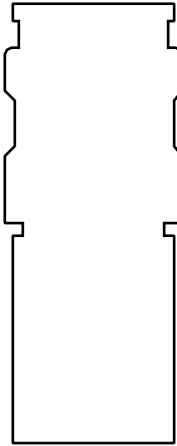

Type:
CI4K
CA4K
CE4K
DE4K

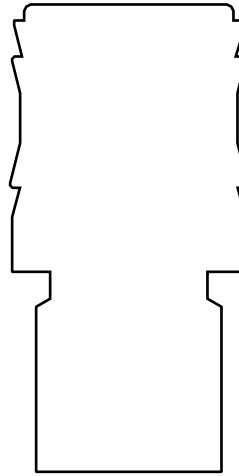

Type:
CI4V
CA4V
CE4V

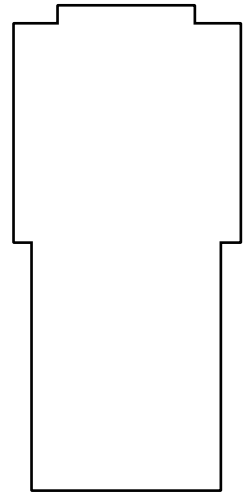

Type:
CI4Z
CE4Z

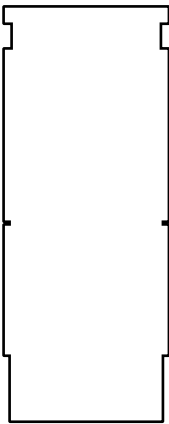

Type:
CI4L
CE4L

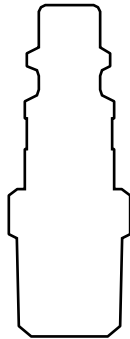

Type:
CI4P

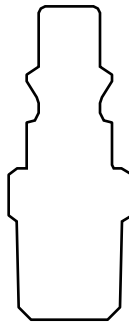

Type:
CA4P

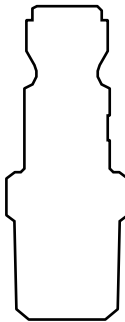

Type:
CT4P

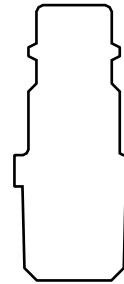

Type:
CE4P
CE4N

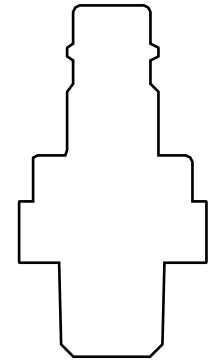

Type:
DE4N

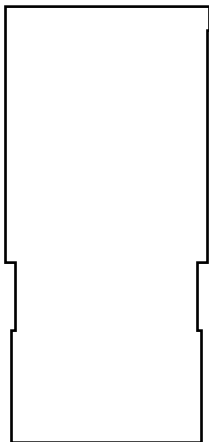

Type:
CI6C
CT6C

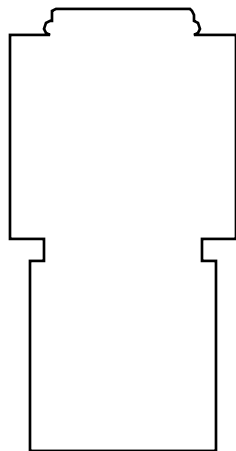

Type:
CI6S

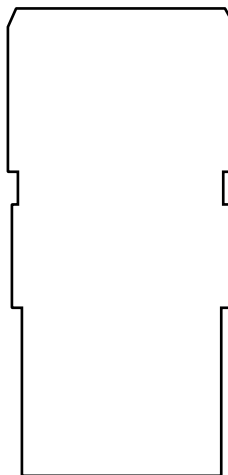

Type:
CA6S

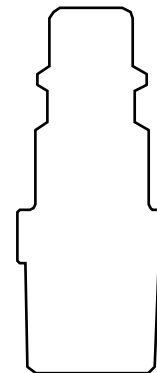

Type:
CI6P

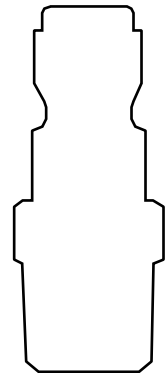

Type:
CT6P

COUPLERS & PLUGS (CONTINUED)

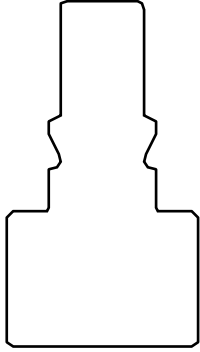

Type:
CA6P

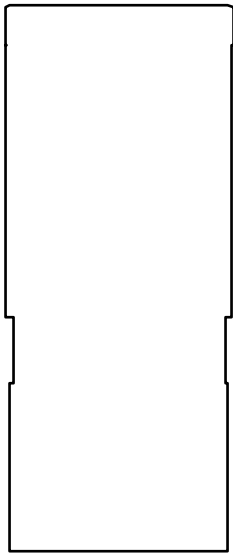

Type:
CI8C

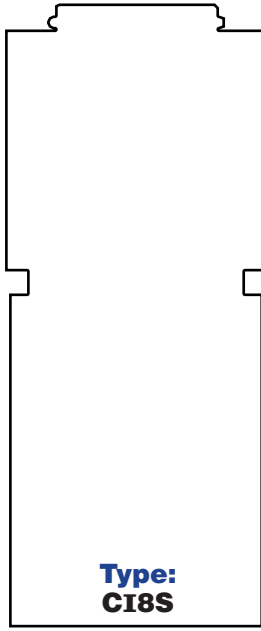

Type:
CI8S

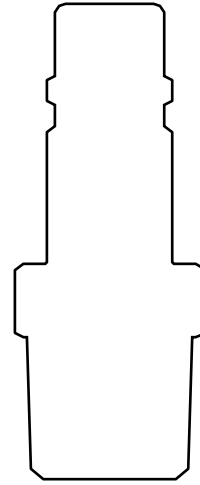

Type:
CI8P

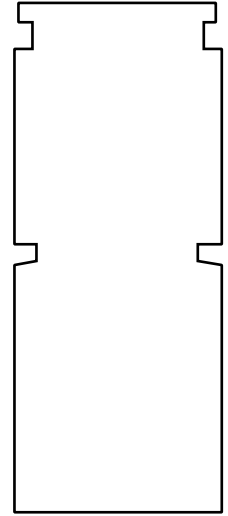

Type:
CE6K

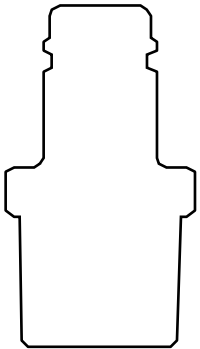

Type:
**CE6P
CE6N**

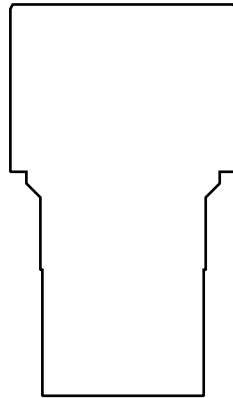

Type:
CS4C

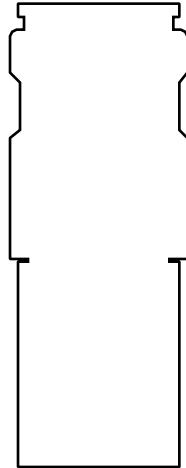

Type:
CS4K

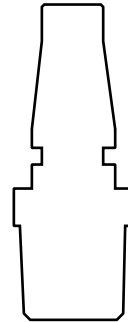

Type:
CS4P



Type:
CL4C

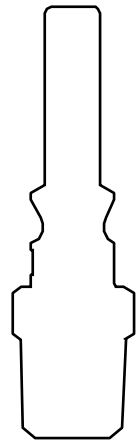

Type:
CL4P

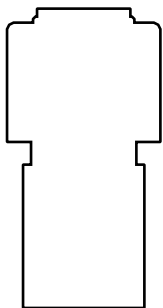

Type:
CM2S

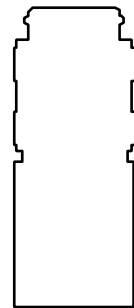

Type:
**CM2K
DM2K**

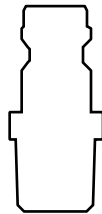

Type:
CM2N

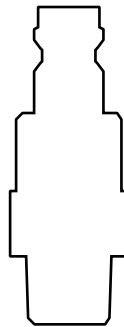

Type:
DM2N

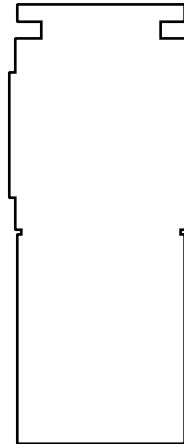

Type:
CB4K

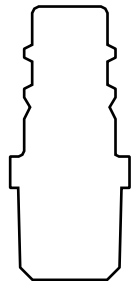

Type:
**CB4P
CB4N**